

Montgomery Heights

Charlottetown's Fastest Growing Residential Housing Development

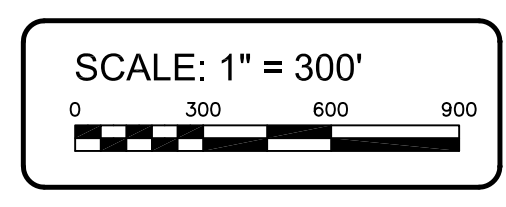
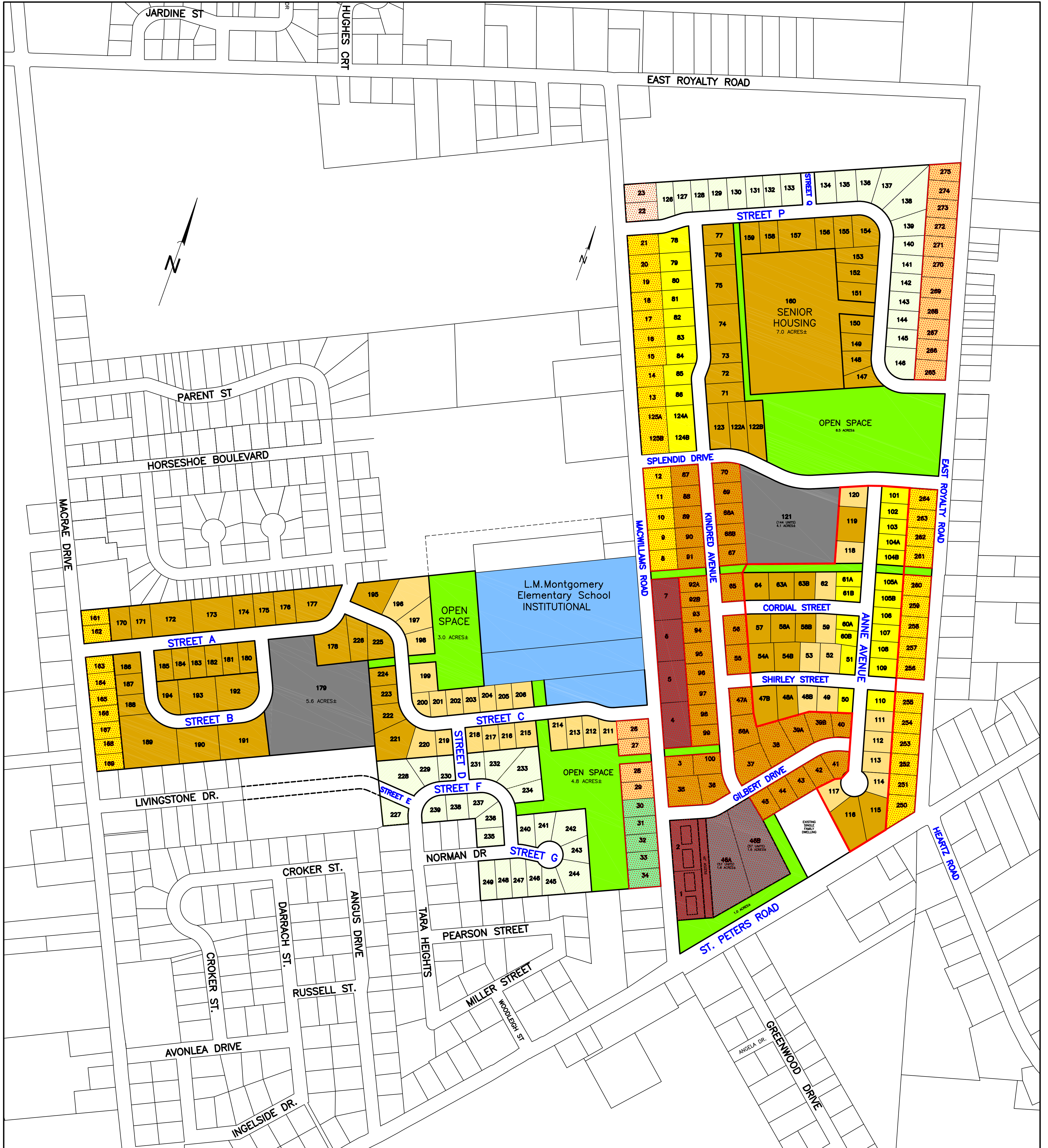

LEGEND:

| | | |
|---|-------|--|
| OS - OPEN SPACE | | |
| R-1L - SINGLE DETACHED RESIDENTIAL (SFD) | | |
| R-2 - LOW DENSITY RESIDENTIAL (SFD, SEMI-DETACHED & DUPLEXES) | | |
| MUR - MIXED-USE (SFD, SEMI-DETACHED, TOWNHOUSES) | | |
| R-3T - MEDIUM DENSITY RESIDENTIAL TOWNHOUSE | | |
| R-4B - APARTMENT RESIDENTIAL | | |
| I - INSTITUTIONAL | | |
| R-2S - LOW DENSITY RESIDENTIAL SINGLE | | |
| R-1S - SINGLE-DETACHED RESIDENTIAL | | |
| LOTS SOLD OR PENDING | | |

CONCEPTUAL ONLY

Prepared by:
Derek A. French, P.Eng., MCIP, PEELS
E: 902-394-2945
F: 902-569-2944
dfrench@peels.com

CONSULTING ENGINEERING PLANNING SURVEYING

Project Title:
RESIDENTIAL DEVELOPMENT
East Royalty
Charlottetown, PEI

Plan Title:
CONCEPT PLAN
"Montgomery Heights"

Date Placed: Jan. 28, 2021
Drawn by: DAF
Job No.: 21018
Plan No.: C1